

# Edward Gideon School

2817 W Glenwood Avenue Philadelphia, Pa 19121

Phone: (215) 400-7360 | Fax: (215) 400-7361

philasd.org/Gideon

Dr. Shauneille Taylor, Principal

Ms. Brenee Waters MEd., Asst. Principal

## INCLEMENT WEATHER PROCEDURES

### Admission

- During inclement students will be admitted to the building at 8:45 am.
- Students will report to assigned areas. Teachers will pick students up from designated areas and escort them to class
- **Parents are not allowed to escort students to assigned areas and/or classrooms.**

### Dismissal

- During inclement weather dismissal will begin at 3:25pm.
- All students K-3 **MUST** be signed out by parent or guardian.
- Students 4<sup>th</sup>-8<sup>th</sup> grade who are picking up younger siblings will be dismissed at 3:30pm to be ready to receive and sign-out their younger siblings.
- **Parents are not allowed to enter the building during dismissal.**
- Parents are to meet lower grade students (K-3) outside near Stairwell C1.
- Upper grade students (4-8) in the main schoolyard.

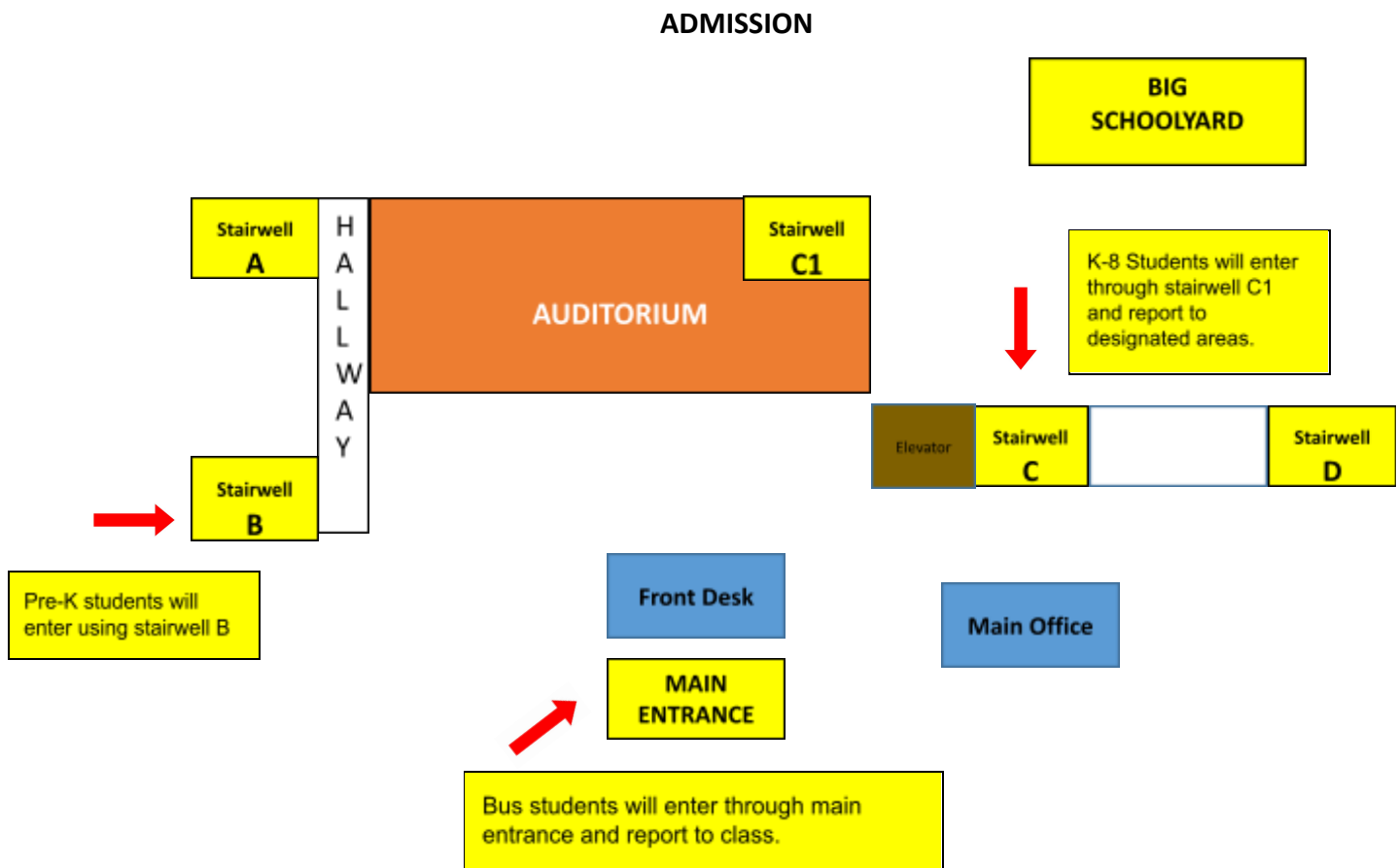

# Edward Gideon School

2817 W Glenwood Avenue Philadelphia, Pa 19121

Phone: (215) 400-7360 | Fax: (215) 400-7361

philasd.org/Gideon

Dr. Shauneille Taylor, Principal

Ms. Brenee Waters MEd., Asst. Principal

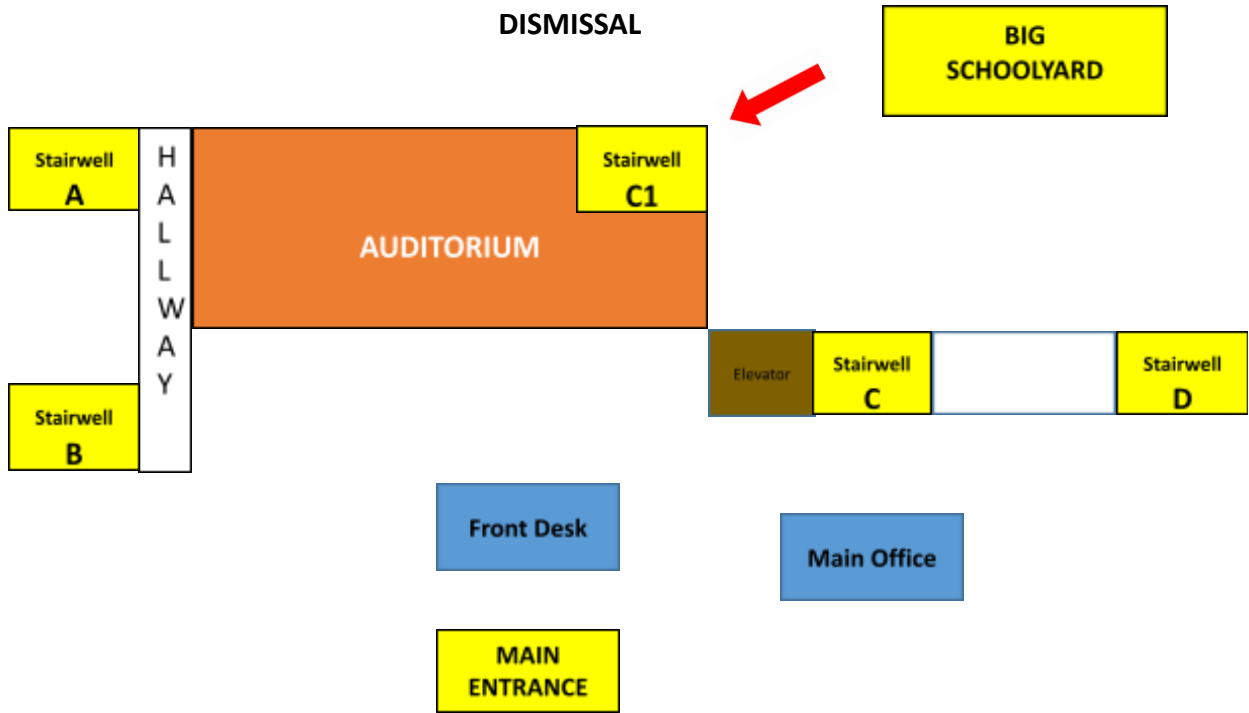

**Entry through the main entrance will not be allowed.**

Grade	Admission Procedure	Dismissal Procedure
Pre-K	Will use stairwell B	Will dismiss using stairway B
K-3	Will go directly to class and be escorted by the classroom assistant	Will use the auditorium. Parents will sign-out students at exit C/1 which is located in the main school yard
4-5	Will use the auditorium and will enter using C/1	Will dismiss in the main school yard
6-8	<ul style="list-style-type: none"> <li>6th grade use room 111 and enter through stairway D.</li> <li>7th grade will use room 105 and enter using stairway A <u>(Thursdays 7th grade will use the auditorium due to Staff Covid Testing)</u></li> <li>8th grade will use room 102 and enter using stairway A</li> </ul>	6-8 will be dismissed in the main school yard.

# **Edward Gideon School**

2817 W Glenwood Avenue Philadelphia, Pa 19121

Phone: (215) 400-7360 | Fax: (215) 400-7361

[philasd.org/Gideon](http://philasd.org/Gideon)

Dr. Shauneille Taylor, Principal

Ms. Brenee Waters MEd., Asst. Principal